

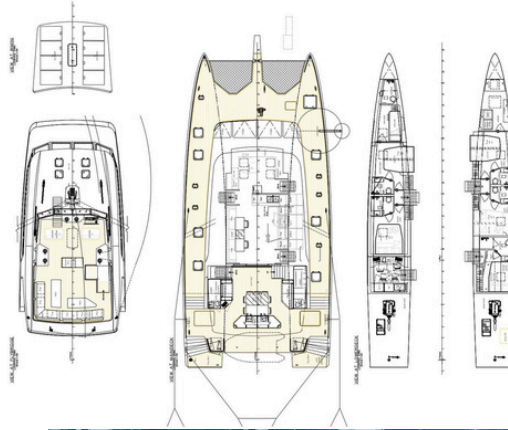

TECNICAL SHEET

CATAMARAN CATMAR EXPLORER 71

GARA ITSASOA

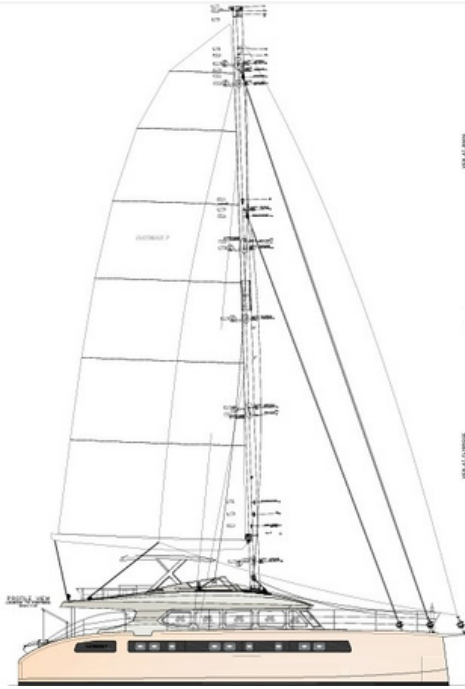

Shipyard: N. Dijkstra Metaalbewerking B.V.

Year of Construction: 07/2025

Material: aluminium

Length: 21,6 meters

Beam: 10,12 meters

Draft: 2,5 meters

Passenger capacity

12 daily departures

8 overnight capacity

Technical Specifications

2 Engines: Volvo D4 Diesel 2x270 HP/199 kW (fuel-efficient)

2 Generators: Solé 20 kVA

2 Watermakers

Air conditioning: DOMETIC

Heating system: Kabola

Sound system: Fusión /Sonos

2 Compressors: compressed air, for scuba tanks

Navigation equipment with advanced technology

Radio communication equipment: (AIS, VHF, Navtex, Thrane & Thrane, etc.)

Internet

Solar panels: 4 units on the bimini roof

Water Ionizer: Kangen 8K (5 pH levels)

Dinghy: 6 seats

Sails: One Sail

Sails: Main sail

Jib

Genoa

Code O

Mast: 29,80 m



Scientific equipment

- Rosette with CTD JFE Advantech
- Underwater robot (ROV Ffish V6 Expert)
- C75 -20OSP Hydrophone
- Microplastics blanket net (CP3 I10)
- Manual plankton net (CP3 75)
- Rinko Profiler Multi parameter handy CTD
- Van Veen dredger SG-400S
- Trinocular stereomicroscope SZTL360
- VCP I30 Vacuum Pump

Wet Lab:

Devid: microplastic collection net (stern, ES, BR)

Dry Lab:

9 Standart 220V power outlets, USB charging parts

Continuous-flow water tap - 24-hour sampling

Refrigerator & freezer for samples

Sample treatment bench

Work desk for computers

Observation balcony

Option to carry research equipment on board



Description of the Gara Itsasoa

Interior Layout

PORT HULL

2 x Double cabins with 2 private bathrooms and showers for guests
 1 x Crew cabin with private bathroom and shower
 1 x Dry lab. equipped with instruments for sample analysis, computer
 1 x Engine room

STARBOARD HULL

2 x Double cabins with 2 private bathrooms and showers for guests
 1 x Crew cabin with private bathroom and shower
 1 x Laundry room with washer, dryer, refrigerators, and freezers
 1 x Engine room

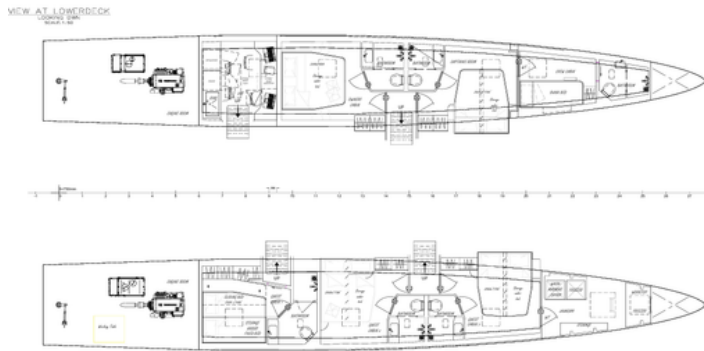

Main deck

Common Areas:

SALOON

A saloon serving as a gathering area with a sofa and two tables that can be joined to form a large table, plus a lounge area for relaxing. A television for screenings.

GALLEY

An open kitchen with a gas stove, oven, 5 burners, 2 refrigerators, wine cooler, 1 freezer, and coffee maker.

COMMAND BRIDGE

Bridge equipped with navigation and radio communication equipment and a navigation table.

COCKPIT

There is a large table that seats 10 people. There are two mats for resting. Two outdoor showers at the stern.

WET LAB.

Wet lab with washing facilities. The dry lab is accessible from the cockpit.

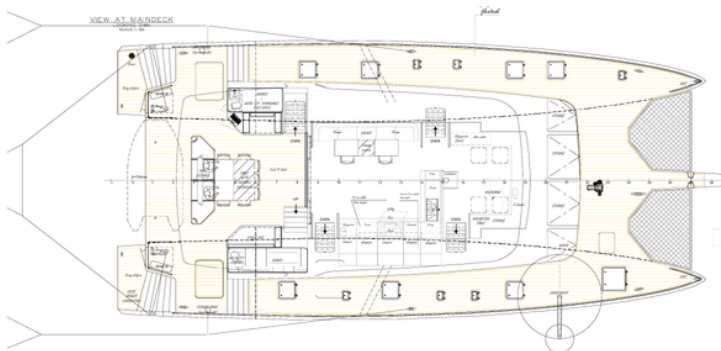

Flybridge

FLYBRIDGE

Flybridge with a lounge area and side tables, separate from the navigation area, which features the helm and hydraulic winches for sail handling.
 A cabinet with a sink and refrigerator.

